

Type AA - Female Threads
Typ AA - Innengewinde
Type AA - İç Dişli Vida
Tipo AA - Rosca hembra

Techn. Data

| Typ | Q max. | P max. |
|-----------|-----------------------|------------------|
| BV3 (1½") | 800 l/min 211 US gpm | 100 bar 1450 psi |
| BV5 (2½") | 1600 l/min 423 US gpm | 70 bar 1015 psi |

Type ED - Swivel Nut
Typ ED - Überwurfmutter
Type ED - Diş Dişli Vida
Tipo ED - Tuerca loca

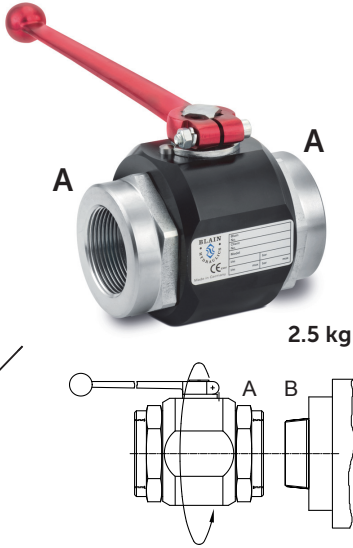

Standard
A - A

Pipe Thread
Seal Tape Required
Rohrgewinde
Dichtband notwendig
Boru dişi
Sızdırmazlık Teybi Gerekirir
Rosca para tubos
Se necesita cinta de junta

Option
E - D

Faster Connections
Perfect Sealing
Schnelle Montage
Perfekte Dichtung
Hızlı Bağlantı
İdeal Sızdırmazlık
Montaje rápido
Estanqueidad perfecta

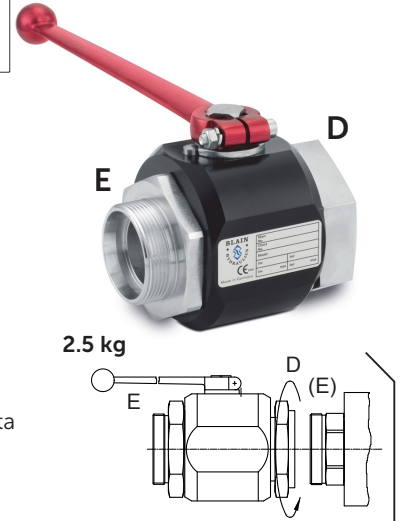

A

| Typ | A | AF* | (BSP) | | (NPT) | |
|-----|-----|-----|---------|----|---------|----|
| | | | Typ No. | LA | Typ No. | LA |
| B3 | 1" | 70 | B3G1 | 19 | B3N1 | 28 |
| | 1¼" | 70 | B3G1.25 | 21 | B3N1.25 | 28 |
| | 1½" | 70 | B3G1.5 | 24 | B3N1.5 | 34 |
| B5 | 2" | 95 | B3G2 | 30 | B3N2 | 34 |
| | 2½" | 95 | B5G2.5 | 31 | B5N2.5 | 35 |

Standard

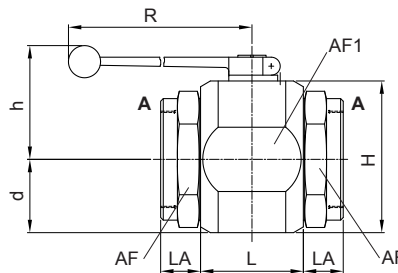

Dimensions

| Typ | DN | L | H | AF1 | d | h | R |
|-----|----|----|-----|-----|----|----|-----|
| B3 | 38 | 65 | 90 | 86 | 43 | 70 | 240 |
| B5 | 55 | 80 | 118 | 114 | 57 | 82 | 280 |

DN = Ø Inside · Ø Innen
Ø İç çap · Ø Interior

E

| Typ | E | α | LE | *AF | DIN 3863 (60°) | |
|-----|-------|-----|------|-----|----------------|--|
| | | | | | Typ No. | |
| B3 | M36x2 | 24° | 24.5 | 70 | B3E36 | |
| | M45x2 | 24° | 26.5 | 70 | B3E45 | |
| | M52x2 | 24° | 26.5 | 70 | B3E52 | |
| | M65x2 | 60° | 27 | 70 | B3E65 | |
| B5 | M78x2 | 60° | 35 | 95 | B5E78 | |

Option

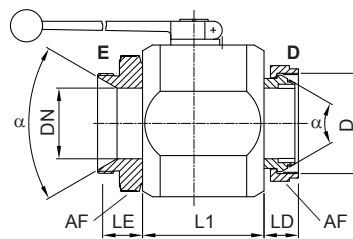

D

| Typ | D | α | L1 | LD | *AF | DIN 3863 (60°) | |
|-----|-------|-----|----|----|-----|----------------|--|
| | | | | | | Typ No. | |
| B3 | M52x2 | 24° | 66 | 35 | 60 | D52 | |
| | M65x2 | 60° | 66 | 25 | 75 | D65 | |
| B5 | M78x2 | 60° | 94 | 24 | 90 | D78 | |

Adaptor GD

| Typ | D | B | *AF | LD | Typ No. |
|-----|-------|----------|-----|----|-----------|
| B3 | M65x2 | G1½" | 70 | 47 | GD65.G1.5 |
| | M65x2 | Ø57 Weld | 70 | 45 | WD65.57 |
| B5 | M78x2 | G2" | 90 | 48 | GD78.G2 |
| | M78x2 | Ø70 Weld | 90 | 44 | WD78.70 |

*AF - Across Flats
AF - Schlüsselweite
AF - Anahtar Büyüklüğü
AF - Ancho de llave

Adaptors

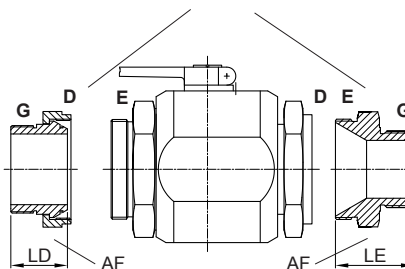

Adaptor GE

| Size | E | B | *AF | LE | Typ No. |
|------|-------|---------|-----|----|------------|
| B3 | M52x2 | G1" | 70 | 55 | GE52.G1 |
| | M52x2 | G1 ¼" | 70 | 54 | GE52.G1.25 |
| | M52x2 | G1 ½" | 70 | 52 | GE52.G1.5 |
| | M52x2 | G2" | 70 | 60 | GE52.G2 |
| | M65x2 | G1 ½" | 70 | 60 | GE65.G1.5 |
| B5 | M65x2 | G2" | 70 | 52 | GE65.G2 |
| | M78x2 | G2" | 80 | 59 | GE78.G2 |
| | M78x2 | G2 ½" | 80 | 59 | GE78.G2.5 |
| | M78x2 | NPT2 ½" | 80 | 63 | GE78.N2.5 |

Blain Hydraulics GmbH
Pfaffenstrasse 1
74078 Heilbronn
Germany
Tel. +49 7131 28210
Fax +49 7131 282199
www.blain.de
info@blain.de



GmbH

Designer and Manufacturer of the highest quality control valves & safety components for hydraulic elevators



Ball Valves İçinde Küresel Valfler

Kugelhähne Llaves esféricas

BV



3/4"

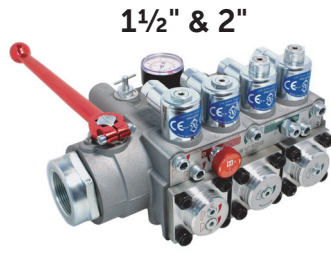

1 1/2" & 2"

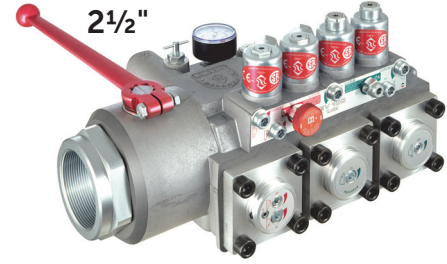

2 1/2"

Standard Connection A

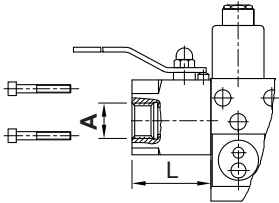

| A | L | Typ No. |
|--------------|----|---------|
| G (BSP) 1/2" | 83 | BG 0.5 |
| G (BSP) 3/4" | 58 | BG .75 |
| G (BSP) 1" | 58 | BG 1 |
| NPT 3/4" | 58 | BN .75 |
| NPT 1" | 58 | BN 1 |

* Reduction

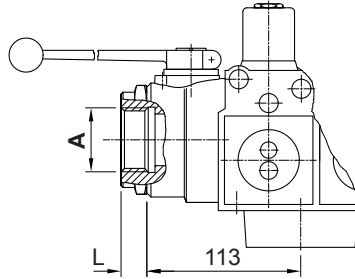

| A | L | Typ No. |
|----------------|----|---------|
| G (BSP) 1" | 19 | BG 1.0 |
| G (BSP) 1 1/4" | 21 | BG 1.25 |
| G (BSP) 1 1/2" | 24 | BG 1.5 |
| G (BSP) 2" | 30 | BG 2 |
| NPT 1" | 28 | BN 1 |
| NPT 1 1/4" | 28 | BN 1.25 |
| NPT 1 1/2" | 34 | BN 1.5 |
| NPT 2" | 34 | BN 2 |

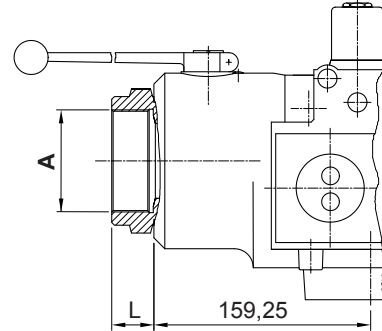

| A | L | Typ No. |
|----------------|----|---------|
| G (BSP) 2" | 31 | BG 2.0 |
| G (BSP) 2 1/2" | 31 | BG 2.5 |
| NPT 2" | 31 | BN 2.0 |
| NPT 2 1/2" | 35 | BN 2.5 |

Optional Connection E

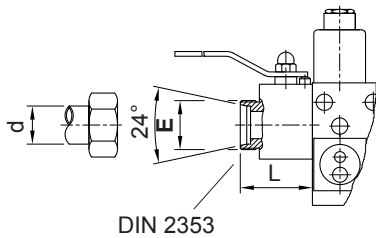

DIN 2353

| E | L | d | Typ No. |
|----------|----|----|---------|
| M 22x1.5 | 80 | 15 | BM 22 |
| M 30x2 | 54 | 22 | BM 30 |
| M 36x2 | 54 | 28 | BM 36 |

* Reduction

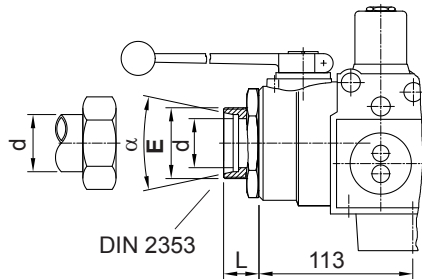

DIN 2353

| E | L | α | d | Typ No. |
|--------|----|----------|----|---------|
| M 36x2 | 23 | 24° | 28 | BM 36.0 |
| M 45x2 | 25 | 24° | 35 | BM 45 |
| M 52x2 | 25 | 24° | 42 | BM 52 |

DIN 3863

| E | L | α | Typ No. |
|--------|----|----------|---------|
| M 65x2 | 26 | 60° | BM 65 |
| M 78x2 | 37 | 60° | BM 78 |

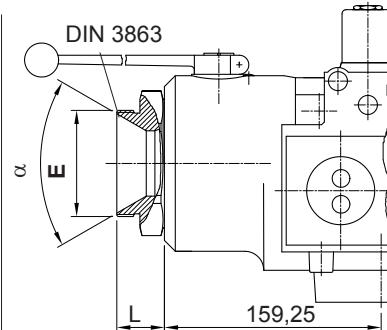

| E | L | α | Typ No. |
|-------|----|----------|---------|
| M78x2 | 35 | 60° | BM 78.0 |

Parts List

BG Grip
BP Limit Pin
BO Shaft O-Ring
BS Shaft
BL Limit Disc
BR Bearing ring
BA Connection
BQ Connection O-Ring
BH Housing
BB Ball
BT POM Seal

Stückliste

BG Griff
BP Kerbstift
BO O-Ring Schaltwelle
BS Schaltwelle
BL Arretierscheibe
BR Gleitring
BA Adapter
BQ O-Ring Adapter
BH Gehäuse
BB Kugel
BT POM Dichtung

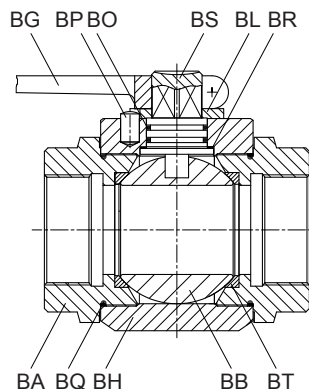

Parça Listesi

BG Kol
BP Sınır pini
BO Şaft O-ring
BS Şaft
BL Sınır Diski
BR Yatak Çemberi
BA Bağlantı
BQ Bağlantı O-ring
BH Korunak
BB Küre
BT POM Seal

Lista de piezas

BG Brazo
BP Pasador tope
BO Junta eje de giro
BS Eje de giro
BL Retén
BR Anillo deslizante
BA Conexión salida
BQ Junta conexión salida
BH Cuerpo
BB Bola
BT Junta de POM